

# ReGrade

Cover More Ground with Lower Horsepower Tractors



## Standard Features

- Solid Bucket Construction
- Front Lift
- Dual Tilt
- Long Drawbar
- Standard Cutting Edges
- Walking Beam Axle
- Ladder and Handrail
- Integrated Tie-Down and Lifting Points

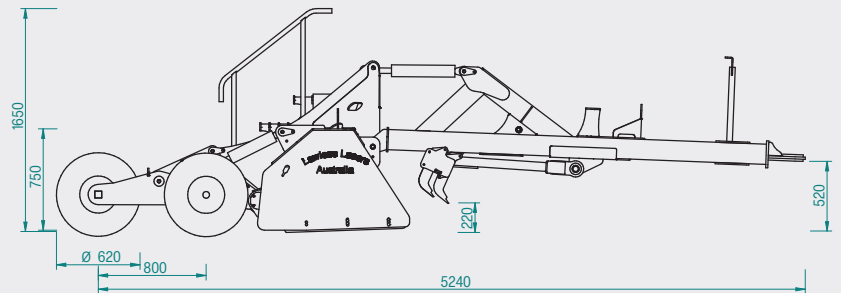

## Options

- Machine Control Package
- Hydraulic Control Valve
- Ripper Bar - Front Mounted

	RG30	RG36	RG42
Horsepower Range	70 - 180	90 - 200	110 - 250
Machine Width (mm)	3000	3600	4200
Cutting Width (mm)	2950	3550	4150
Length (mm)	5600		
Approx. Capacity (m <sup>3</sup> )	0.65	0.85	1.10



CELEBRATING **40 Years**

# AUSTRALIAN MADE EARTHMOVING EQUIPMENT

---



## Tilt Module

- **Level Stop** - Quickly Reference to Level by Retracting Tilt Cylinders
  - **Independent Tilt** - Left and Right Independent Control
  - **Automatic Control** - Works with Slope Sensor or 2nd Receiver
  - **High Lift** - Increase Ground Clearance During Transport
- 



## Walking Beam Axle

- **Increases Stability** - Improves Efficiency Through High Finishing Speed
  - **Large Wheel Offset** - Reduces Effects of Uneven Terrain
  - **Standard Wheels and Bearings** - Easy to Replace, Available Nationwide
  - **Unique Pivoting Position** - Maximises Walking Beam Performance
- 



## Mast Mount

- **Ladder** - Allows Easy Access to Mast and Receiver
  - **Handrail** - Reduces Risk of Falling
  - **Improved Operator Safety** - OHS Compliant
  - **Platform Style Steps** - Provides Operator with Secure Position to Adjust Receiver
- 



## Ripper Bar

- **Drawbar Mounted** - Built Strong and Easy to Observe in Operation
  - **Standard Points** - Off the Shelf Replacement Parts Available Australia Wide
  - **Multi-Position Settings** - Allows for Depth Control
  - **Break Out** - Replaceable Sheer Bolt
-